

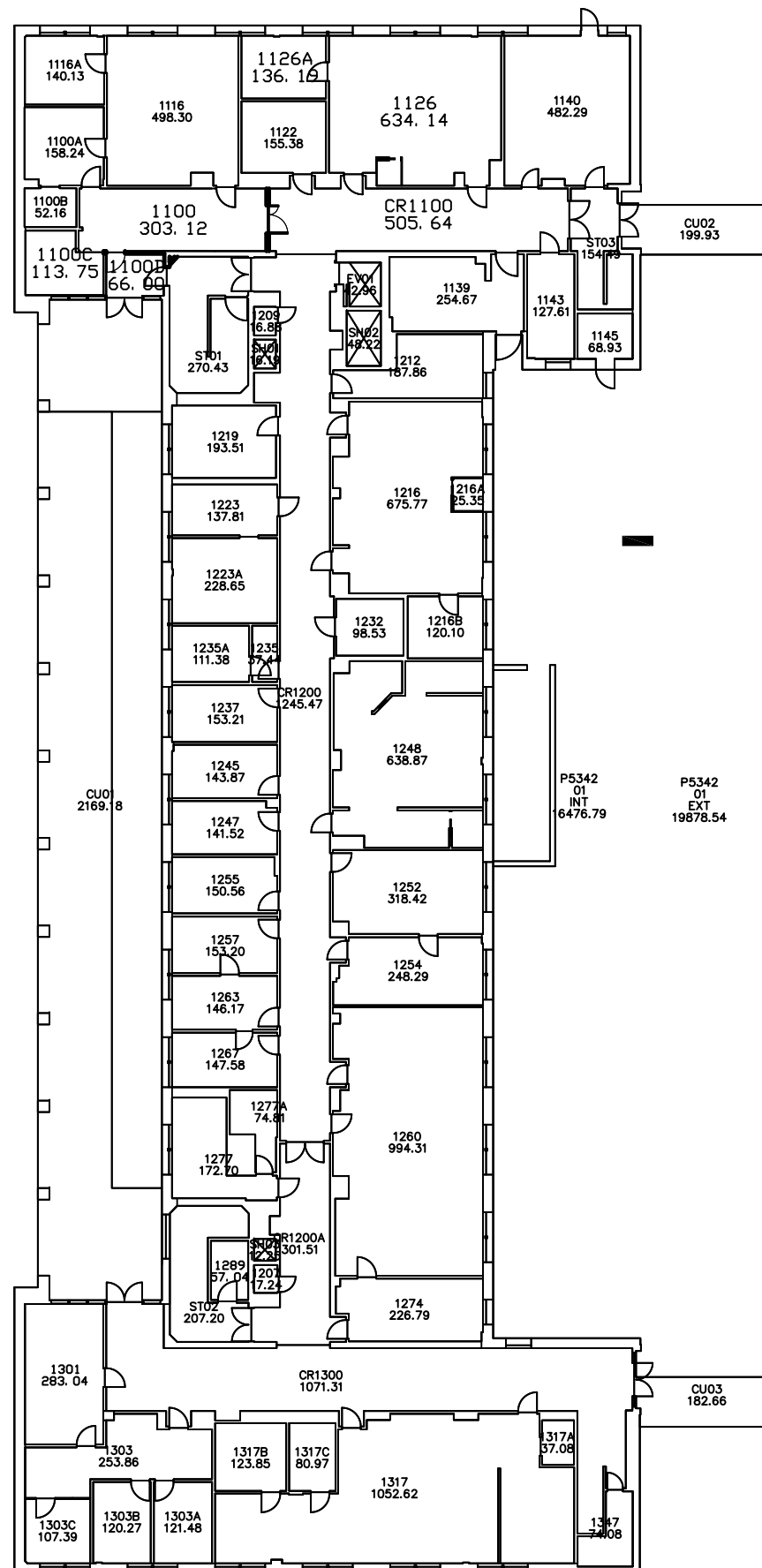

UNIVERSITY OF CALIFORNIA RIVERSIDE

OFFICE OF:

CAPITAL AND PHYSICAL PLANNING  
3637 CANYON CREST ROAD, SANNOCKBURN F101  
RIVERSIDE, CA 92507  
PH: (909) 787-2431 FX: (909) 787-2402



CAAN #: P5342

DRAWN BY:

BP

PROJECT NO:

N/A

DATE:

01/13/03

BUILDING NAME:

WEBBER HALL  
BUILDING

LEVEL:

FIRST FLOOR

SHEET NO:

01

SCALE: N.T.S

DRAWING FILE:

X-P5342-01.DWG